

Product Features

- to avoid stagnation in cold water (PWC) and hot water (PWH) pipework
- KHS Flow-Splitter - dynamic, according to the Venturi principle, including dynamic cartridge, flow and return branch for connection of outlets / plumbing units
- wetted metal parts made from dezincification-free, corrosion-resistant and lead-free gunmetal, resistant against aggressive water
- KHS Flow-Splitter pass with female thread
- plumbing unit feed pipe with female thread
- plumbing unit return pipe with female thread
- maintenance free
- free from dead spots
- including KHS stop valve, female threaded, figure 389 00
- maintenance-free EPDM spindle seal
- removable inner top part TOP-ENTRY, with EPDM gasket body and gunmetal ball
- incl. insulation shell

Standards and Approvals

- NSF/ANSI 61 & NSF/ANSI 372
- IAPMO/IGC 302

Technical Data

- pressure rating PN 16
- max. operating temperature 194 °F

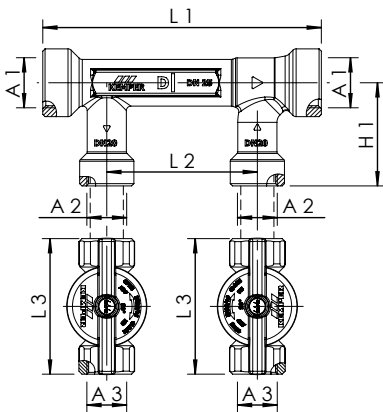

part no.	A1	A2	A3	H1	L1	L2	L3	weight
				in	in	in	in	lbs
6510601500	FPT 1/2	FPT 1/2	FPT 1/2	1,9	7,3	3,9	3,3	0,78
6510602000	FPT 3/4	FPT 3/4	FPT 3/4	2,3	7,3	3,9	3,5	0,97
6510602500	FPT 1	FPT 3/4	FPT 3/4	2,7	7,3	3,9	3,5	1,08
6510603200	FPT 1 1/4	FPT 3/4	FPT 3/4	2,9	7,7	3,9	3,5	1,14
6510604000	FPT 1 1/2	FPT 1	FPT 1	3,1	8,1	3,9	3,9	1,60
6510605000	FPT 2	FPT 1	FPT 1	3,5	8,6	3,9	3,9	1,96